

LINEAR LIGHT LED WRAPAROUND LIGHT



Project:

Location:

Cat No:

Type:

Qty:

Notes:

About:

Perfect energy-efficient and cost-effective wrap around light designed for basic utility and commercial applications.

SKU: AOLF-LR-002-LAB001-02-S

LENGTH	WIDTH	LUMENS	CCT	CRI	DIMMING	MOUNTING	FINISH
<input type="text"/>	<input type="text"/>	<input type="text"/>	<input type="text"/>	<input type="text"/>	<input type="text"/>	<input type="text"/>	<input type="text"/>
2-2'	7.1-7.1"	28-2860 (22W)	35-3500K	80	DIM	MS	WH
				80-80	DIM - 0-10V	MS-Surface	WH-White
4-4'	9.4-9.4"	39-3250 (25W)	40-4000K				
		52-4420 (34W)	50-5000K				
		59-5200 (40W)					

LINEAR LIGHT LED WRAPAROUND LIGHT

Size-2ft x 7.1in

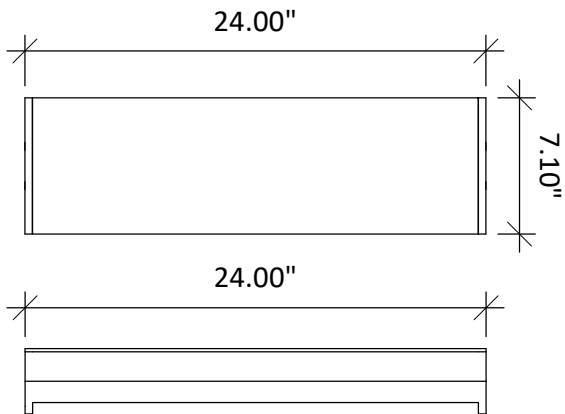

Size-2ft x 9.4in

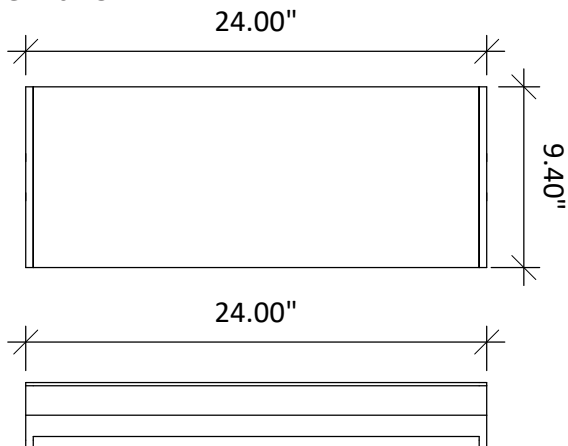

Size-4ft x 9.4in

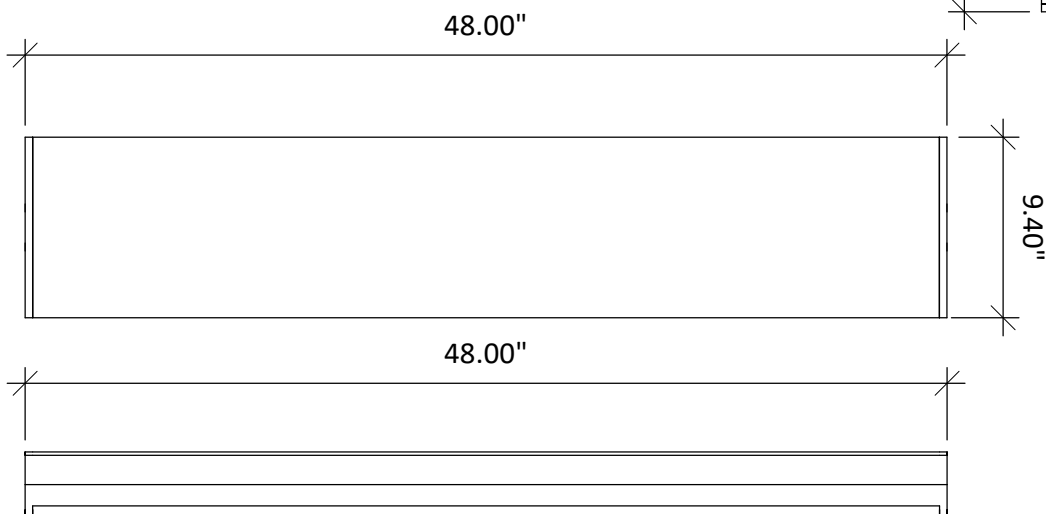

Size-4ft x 7.1in

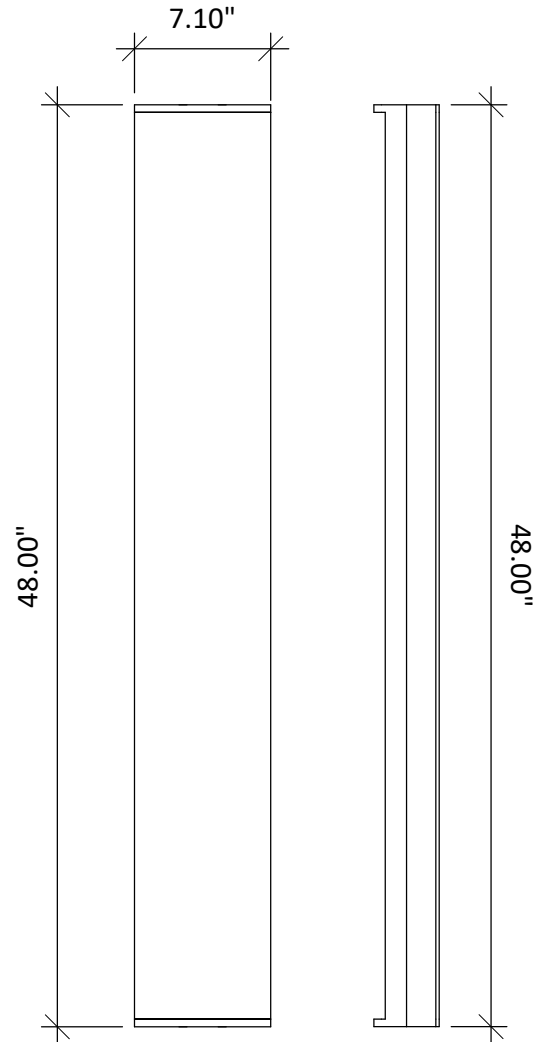

LINEAR LIGHT LED WRAPAROUND LIGHT

FEATURES:

- Designed with high efficacy LED engine to get the most energy savings.
- Suitable for damp locations.
- Continuous type 0-10V dimming can dim 10%-100%.

APPLICATION:

- Offices, Utility rooms, Multifunction rooms, Hallways, etc.

WARRANTY:

- 5 Years

TECHNICAL CHARACTERSTICS:

Input Power	22W, 30W, 40W, 46W
Input Voltage	120V to 277V AC
Frequency	50/60 Hz
Efficacy	130Lm/W for 5000K
Operating Temperature	-4°F to 122°F
Lifespan	>100,000 Hours
Water Resistance	Damp Rated
Mounting	Surface
Certifications	UL 1598, UL 8750, DLC Listed